

*The big CHANGE*

CREATING A KITCHEN-DINER AND PUTTING IN SLIDING GLASS DOORS

# Create a seamless link with the garden

Stuck in a gloomy terrace? Open it up with a palette of soft, chalky colours and an outdoor living room like Hannah and Richard Gooch did

FOR WHERE TO BUY ITEMS SHOWN, TURN TO OUR SHOPPING DIRECTORY



**1 Kitchen**

The new sliding doors fill the room with light and provide an effortless step into the garden and decked patio. Ikea unit carcasses were customised by Hannah with panelled doors she made. 'Bespoke units like this started at £7,000,' says Hannah, 'but ours came in at £2,000'. New England Old White extending table, £1,399, Multiyork. Units painted in Pavillon Gray Estate Eggshell, £48.50 for 2.5ltr, Farrow & Ball

## Take the 60-SECOND TOUR

BOUGHT FOR	SPENT	NOW WORTH
£246,500	£36,800	£380,000

**THE PROPERTY**

A three-bedroom, early Edwardian terrace in Eltham, southeast London, bought in August 2005.



**WHAT IT COST**

Building work.....	£10,000
Patio doors.....	£4,000
Kitchen units and worktops.....	£2,800
New windows.....	£9,000
Bathroom.....	£6,000
Garden.....	£2,000
Fireplaces.....	£2,000
Decoration.....	£1,000
<b>TOTAL.....</b>	<b>£36,800</b>

**WHO LIVES HERE**

Hannah and Richard Gooch, with son Oliver, two. Hannah is a former design manager for John Lewis and now runs an online interiors business. Richard is a design director for a media company.

**THE LOOK**

Understated period elegance with a modern edge, thanks to a neutral

colour scheme and a mix of pared-back decorating and statement pieces.

**LESSONS LEARNED**

“Don't be daunted by DIY – you'll get better with practice. And varnish oak worktops! A hot cup of tea left a ring behind on ours so we varnished them with a water-based, heat-resistant varnish.”

**FIRST FLOOR ▶**  
The main bedroom and son Oliver's room are at the front of the house, while the guest room and family bathroom are at the back

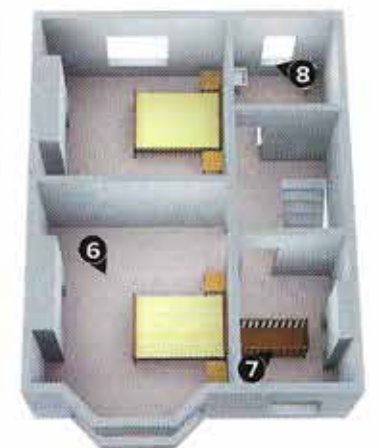

**◀ GROUND FLOOR**

The living room is at the front of the house, while at the rear is the open-plan kitchen and dining room with sliding doors to the decked patio and garden. A small utility room/loo leads off the dining room





**OUTDOOR ROOM**  
Create an external 'living room' with decking and a sofa for chilling out

## Brush up on your DIY skills

Hannah tackled much of her home's refurb herself. You can too with a bit of tuition

■ **Carpentry** If you're all fingers and thumbs when it comes to sawing and hammering, then try a You Can Do It class in Skirting & Architraves at B&Q. The three-hour session costs just £10. Call 0845 600 5428 or go to diy.com.

■ **Plumbing** A blocked U-bend or leaking tap will no longer require a call to the plumber once you've completed a

weekend course with Chix & Mortar. The two-day course costs £199 and includes decorating and tiling instruction, too. Call 0845 094 6391 or go to chixandmortar.com for more information.

■ **Tiling** You'll be able to tile a splashback or around a bath after a Weekend DIY Tiling Course with Able Skills. The school is situated in Dartford, and the two-day

course costs £195. Accommodation can be provided for just £20 per night. Call 0808 100 3245 or go to ableskills.co.uk.

■ **Decorating** A longer four-day course at The DIY School will teach you all you need to know about painting and papering. Courses cost £350 and are held in Stockport. Visit thediyschool.co.uk or call 0161 477 4270.

2 **Garden room**  
The garden has been completely re-landscaped with a decking area and gravel leading to the lawn beyond. The decked area becomes the family's main living space in the summer. 'It's great for our son Oliver,' says Hannah. For a similar sofa, try the Rattan effect sofa (part of a four-piece set), £599, Argos. For a similar planter, try the Geo Cube, from £79.99, Crocus



3 **Dining space**  
Hannah's muted colour scheme has not only transformed the once-dark space, but also allowed her carefully chosen statement pieces to make more of an impact. Weston pendants, £65 each; Jim Lawrence Constellation mirror, from £150; Laura Ashley

Hannah and Richard Gooch's house is a great summer home - not because it's near the beach (the closest body of water is the Thames) but because the couple have created a space that really comes into its own when the sun is out. As soon as the warm weather arrives, the couple and their young son Oliver spend every minute they can in the second 'living room' they've made in the garden of their London terrace.

What was your average outdoor space when the couple moved in nearly seven years ago has been turned into an oasis in the city, with a decked area that becomes an extension of the large kitchen-diner thanks to a wall of sliding glass doors. 'It means we can be inside and outside at the same time in summer,' says Hannah. It was Hannah who found the house and saw its potential when it came on to the market in July 2005. 'I was born and raised in Eltham, so I knew it was a good area,' she says. 'Richard and I had been looking for a place for a while, so when this house came up as a private sale, a bit run-down but within our budget, we put in an offer and instructed

our solicitors within 48 hours.' A bit run-down is a slight understatement - before Hannah and Richard could even think about the outside space of the house there were more pressing issues to deal with inside. 'We had to replace the boiler pretty sharpish,' says Hannah. 'It was about 25 years old and actually caught fire! A heating engineer had come round to see why the boiler's fuse kept blowing. When he turned on the pilot light it triggered a small fire that melted the inside of the boiler door. We were just very, very lucky that it didn't explode or burn the house down.' That wasn't the couple's only close shave. 'Our chimney sweep couldn't get his broom up the living room chimney. He set off a smoke pellet and smoke came pouring out. That's how we discovered that builders, at some point, had capped off the chimney, which was attached to a working gas fire. We could have been poisoned by all sorts of toxic fumes.'

Thankfully, this is all a far cry from the welcoming living room it is today, where a reproduction fireplace insert and marble surround now take pride of place and a dark Sixties décor, which was prevalent throughout the house, has given way to a neutral. →





'We're so lucky living here. We live 20 minutes from central London, but we've still got a big garden'



3 of the best GILT MIRRORS

£395

**Big it up**  
The ultimate mantelpiece mirror  
Miss Lala's Gold Looking Glass, The French Bedroom Company

£195

**Go grand**  
Dress up your dresser  
Guildford mirror, The Chandelier & Mirror Company

£149

**Let the sun shine**  
A modern take on gilt  
Fantastic Gold Gilt Sun wall mirror, Ayers & Graces

Get the LOOK PAGE 59



**Colours to try...**  
Be inspired by Hannah's palette of chalky off-whites

**SMOKY MIST** matt emulsion, £17.48 for 2.5ltr, Crown Neutrals range, Homebase

**VELLUM** matt emulsion, £29.50 for 2.5ltr, Fired Earth

**JUST WHITE** Standard Claypaint, £29.40 for 2.5ltr, Earthborn

**CHIFFON WHITE 4** matt emulsion, £31 for 2.5ltr, Tailor Made Colour range, Dulux

**TALLOW NO 203** Estate Emulsion, £32.50 for 2.5ltr, Farrow & Ball

**4 Living room**

Richard's dad – a carpenter – built a cupboard in each alcove for storage. Richard and Hannah added antique-style hardware to make them look like an original feature of the house. For a similar mirror, try the Large Rococo Styled mirror in White, £235, Beau Decor. Mortimer leather sofa, from £1,400, Laura Ashley

light and airy scheme. Off-whites, muted neutrals and chalky greys have been used throughout the house and are the perfect background for the vintage-style pieces Hannah buys not only for her home, but also for her online interiors business – Ebury Home & Garden. The scheme also lets the period fireplaces, coving and ceiling roses the couple have lovingly restored really stand out. 'I found a great product called PeelAway, which got off layers of dark paint on the coving and ceiling roses,' says Hannah.

Hannah is one of those handy individuals undaunted by practical projects like this. 'DIY doesn't frighten me,' she says. 'When we moved here, I already had my own sander, drill and toolbox. I was out in the garden laying the turf while Richard and his dad stood there watching me with a cup of tea in their hands. I also did the tiling and the wallpapering in our bedroom and laid all the floorboards in the kitchen. And I ended up painting the walls in the hall, right to

the landing ceiling, up a 20ft ladder.' Hannah developed quite a few new DIY skills during the renovation, too. 'I'm now quite good at carpentry after building the kitchen units myself,' she says. 'We'd seen lots of gorgeous bespoke kitchens but we just didn't have the budget for one, so I used Ikea's online planning software to design an Ikea kitchen, but leaving sufficient space to build our own wooden frames to encase the standard Ikea carcasses. I also made the panelled doors.' What is really impressive, though, is that Hannah was eight months pregnant while she was building the units. 'The oak worktops arrived the day I had Oliver,' she says. 'It was very bad planning really and I wouldn't do it again. Every time he had a nap I'd get into the kitchen to oil the worktops. I was delirious for want of sleep! But we did it. And we stuck to our budget, too.'

Hannah did leave some of the work to the professionals – renovating the avocado-green →

**6 Entrance**

The haberdashery chest was an eBay find that Hannah refreshed with paint. Hannah paid a glazier about £300 to replace two broken panels in the door as she loves how the intricate glazing provides privacy but also lets the light in. For a similar chest of drawers, try the Bramley, £900, Laura Ashley





**ⓐ Main bedroom**  
The wallpaper was a great find as it's in the muted shades Hannah loves but also has an intricate pattern that lifts the space. The bedside tables were a £20 eBay bargain. Antoinette bed, from £799, Newtons Furniture Company. Silvergate wallpaper, £88 per roll, Farrow & Ball

'I did the wallpapering in here and I ended up painting the walls in the hall, right to the landing ceiling, up a 20ft ladder'



**ⓑ Oliver's room**  
The simple scheme is a classic that will work even when son Oliver is a teen. Old English 23cm Antique White wooden letters, £9.50 each, Posh Graffiti. Tin plate bus, £31.99, Tin Plate Collectables. Walls painted in French Grey Pale Absolute Matt Emulsion, £30.50 for 2.5ltr, The Little Greene Paint Company



**ⓐ Bathroom**  
An extended tiled splashback adds interest to the neutral scheme. For a similar wall light, try the Single Morston, £81, Jim Lawrence

bathroom and converting the separate kitchen and dining room into one big space that opens out into the garden. 'The builders knocked down the wall that separated the two rooms and, as they had removed most of the back wall for the sliding glass doors, they had to put in a huge steel box frame to stabilise the back wall before the doors went in,' says Hannah. 'From the day the builders started to the day the kitchen worktop finally arrived took about eight weeks in total, which is not bad going. We also got someone in to do the garden decking as we were too tired by then to do it ourselves!'

The large patio doors have really made a difference, and not just by linking the inside of the house with the garden. 'They also just make the kitchen feel like a much bigger room than it actually is,' says Hannah, who never sees herself moving anywhere else now. 'We're so lucky living here, it would be difficult to move,' she says. 'We have lovely neighbours, we live 20 minutes from central London, but we've still got a big garden, and the countryside is just five minutes down the road.' She can't seem to get rid of the DIY bug, though. 'I was in this really old-fashioned local hardware shop to buy some bits and found a whole back room filled with banisters and finials. I said to Richard: "Oh my God I love it here..." with the same awed reverence and enthusiasm that most women reserve for their favourite shoe shop!'

FEATURE LIZ POTTER STYLING CHARLIE DAVIS PHOTOGRAPHS HEATHER HOBHOUSE PLANS PERSONA-HD



# Get Hannah's look

Be timeless but unique with classic pieces and quirky finds

FOR WHERE TO BUY ITEMS SHOWN, TURN TO OUR SHOPPING DIRECTORY

**IDEAL**

**Love it**  
From the queen of embroidery  
Union Jack lavender heart,  
Jan Constantine



£33.50

**Timepiece**  
The sleek curves  
give it a modern feel  
The Mantelpiece clock in  
Black, Newgate

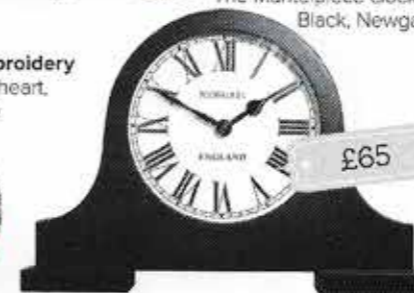

£65

**GREAT DEAL**

**Clock this**  
Amazing price  
Jones & Co Blackham  
mantel clock,  
Tesco Direct



£15

**Cute as a button**  
But minus the lavender  
Union Jack heart, East  
of India range, Mollie & Fred



£5.99

**Red, white and blue**  
Classic colours that  
never go out of style  
IOS striped cushion, Linum



£36



£10

**Big stripes**  
Be a bit bolder  
Coastal Stripe  
cushion, Tu range,  
Sainsbury's

**Smooth operator**  
Has the simple, clean lines  
you need for a timeless look  
Stockholm coffee table, Chic Shack



£399

**Simply brilliant**  
Doesn't have the curved  
detailing, but look at that price tag  
Hemnes coffee table in White, Ikea



£115

**Turn on**  
Equally dramatic (and fun)  
Libra Blake floor lamp, John Lewis



£595

£1,280

**Old school**  
The leather has a lovely worn look  
Belgravia leather sofa, Darlings of Chelsea



£949

£200

**Really rich**  
The chocolate brown leather is delicious  
Fraser medium sofa, Marks & Spencer